

# Tëwën ë EpiPen® Ƴe Tuöm GamThin

## (How to give EpiPen®)

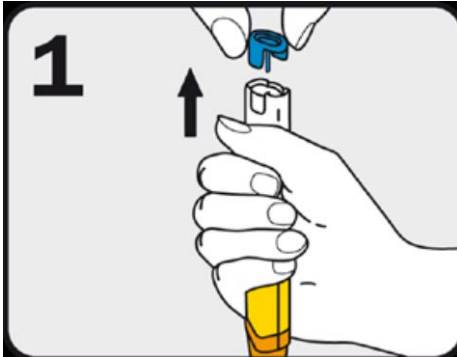

1. Döm ba cïn njëc dol ë wïnh cöl EpiPen kôu apiath ku miit kë macär-nök ðen bei wën ë wïnh tit bë röt liëp.

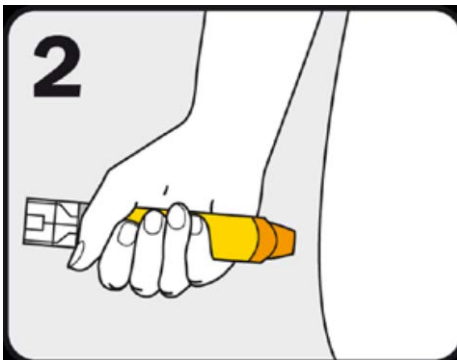

2. Täu ë wïth thok alon Ƴe tiŋ ke mamer aƳer Ƴäm-kôu ciëlic (kë ulä këcïn alanh rëer thïn ).

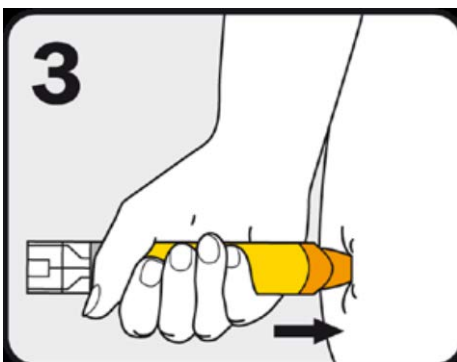

3. Piëk wïth apei në riël ë Ƴäm-kôu agut të na cä röl jal pïŋ ulä yök yïn guöp ku muk thin tënë thikän kathiär (10 seconds).

NYÄI EpiPen. Kiëny tëwën cï tom thok tënë thikän kathiär (10 seconds).