

## How to give EpiPen®

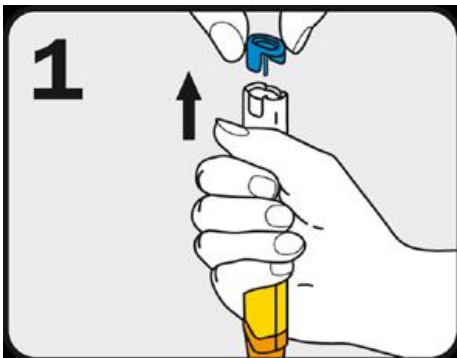

1. Form fist around EpiPen and PULL OFF BLUE SAFETY RELEASE.

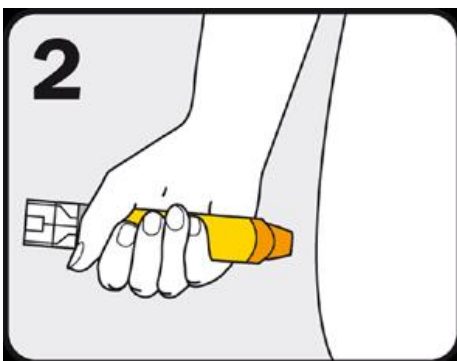

2. PLACE ORANGE END against outer mid-thigh (with or without clothing).

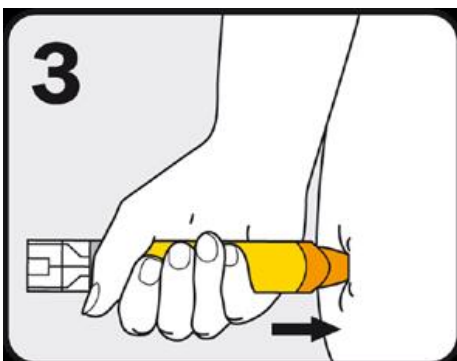

3. PUSH DOWN HARD until a click is heard or felt and hold for 10 seconds.

REMOVE EpiPen. Massage injection site for 10 seconds.